

The division that was done by Mr. William Thompson the 7th July 1794 - as per Map Surveyed by Andrew Thompson the 18 July 1794 -

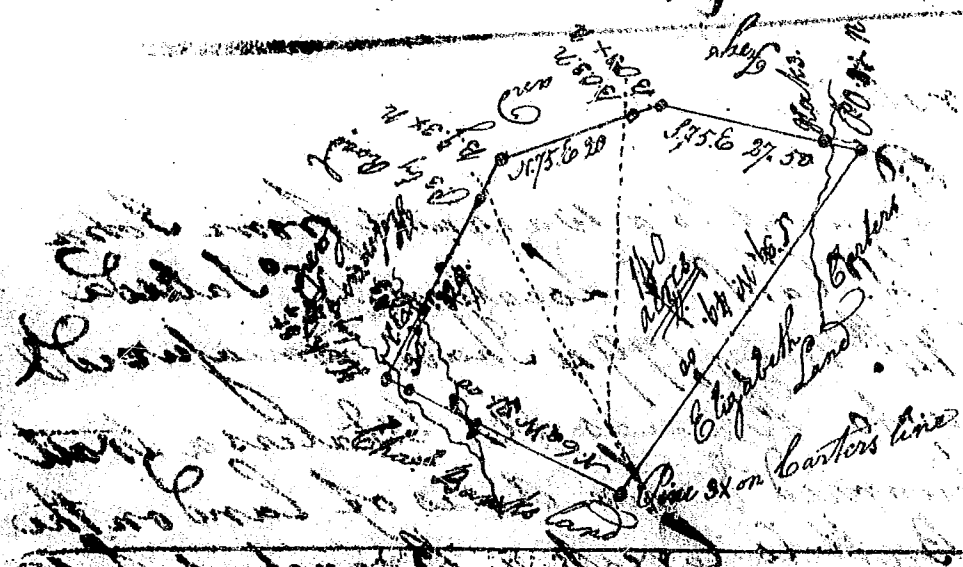
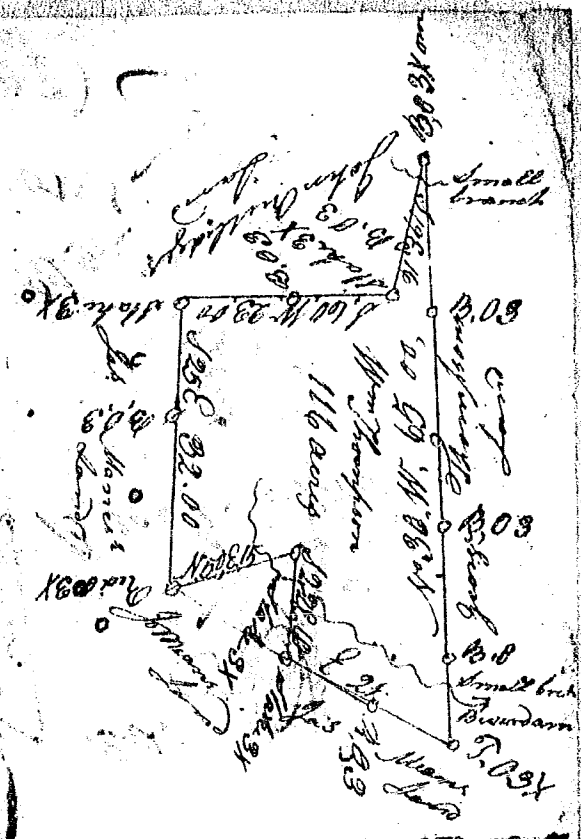

State of New Hampshire

James Wright Surveyor and from John Thomas Esq. Comr. of
 the Location N. Saluda dated the 15th July 1795 I have admeasured
 and laid out unto Silas Carter a tract of One hundred and forty
 rods of Land in Buffets lot of Saluda River bounding to the
 East by Carters land and on all other sides by Jays Robinsons
 and Charles Banks's land and hath such shape and Marks as the
 above plat Represents
 Surveyed the 28th July 1795
 Wm Wright D^y